

Level indicators

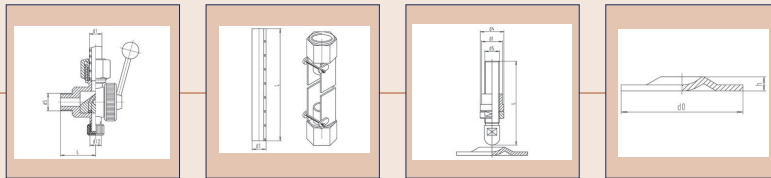

On the following pages you will find the article numbers required for inquiries and orders of the **Level indicators**, accessories, and spare parts of our catalogue program.

You will also find drawings with the installation dimensions.

The description of the products and all technical data sheets will be available on our new website, soon.

If you have any question, are looking for a different version, or if you would like to place an order, please send an e-mail to our sales team at sales@nocado.de.

Please keep in mind that it's necessary that you have to define and communicate the following characteristics so that we can process your request:

1. Product type / version
2. Size
3. Material steel with product contact
4. Material seals with product contact
5. Finish steel
6. Tube connections

Instead of the a.m. characteristics you can send us the **Nocado article number**.

Notice:

All products of Nocado GmbH are under constant technical review. So, changes are reserved. Therefore, the technical data, images, and descriptions in our catalogue are therefore non-binding and exclude claims that may be derived from them.

The data in our catalogue is based on the status at the date of its publishing. Earlier catalogues become void, automatically.

All rights are reserved by Nocado GmbH. Reprints, copies, translations, and use on your websites or in your webshop, even if only partially, require the prior written approval of Nocado GmbH.

4.3 Level indicators

4.3.1 Level indicators	page
Level indicator valve (792)	4.3.1-1
Upper part f. level indicator glasses (790)	4.3.1-1
Middle part f. level indicator glasses (791)	4.3.1-1
Glass tube / protecting tube for level indicator	4.3.1-1

4.4 Attachments

4.4.1 Attachments • Structural attachments	page
Spherical cap base (930K)	4.4.1-1
Base disc for height adjustable stainless steel feet, 3/8" to 1 1/2" (930T)	4.4.1-1

level indicator vent (792)

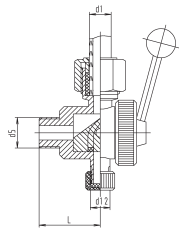

DN	d1	d5	d12	l	weight (kg)
10	15	R 1/2"	R 1/4"	42	0,470

upper part f. level indicator glasses (790)

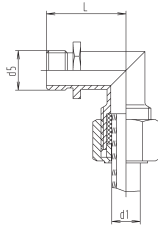

DN	d1	d5	l	weight (kg)
10	15	R 1/2"	42	0,18

middle part f. level indicator glasses (791)

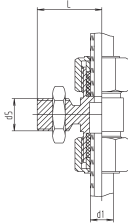

DN	d1	d5	l	weight (kg)
10	15	R 1/2"	42	0,250

glass tube / protecting tube for level indicator

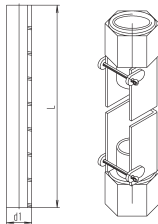

DN	d1	l	weight (kg)
10	∅ 15 x 2,5	nach Angabe	-

t-pieces, short, DIN 11852 (for tubing acc. DIN 11850 line 2) (311IN)

DN	304 glass polished Ident number	304 plexiglass polished Ident number	O-Ring FPM 19 x 3,5 Ident number	o-ring FPM 21,5 x 3,5 Ident number
10	● 179.04.11Y.0002	● 179.04.11Y.0003	○ 827.00.6V0.0011	○ 827.00.6V0.0015

t-pieces, short, DIN 11852 (for tubing acc. DIN 11850 line 2) (311IN)

DN	304 glass polished Ident number	304 plexiglass polished Ident number	crushing gasket glass Ident number	crushing gasket plexiglass Ident number
10	● 179.04.11N.0000	● 179.04.11N.0001	○ 279.04.5N0.0019	○ 279.04.5N0.0034

t-pieces, short, DIN 11852 (for tubing acc. DIN 11850 line 2) (311IN)

DN	304 glass polished Ident number	304 plexiglass polished Ident number
10	● 179.04.11N.0005	● 179.04.11N.0007

t-pieces, short, DIN 11852 (for tubing acc. DIN 11850 line 2) (311IN)

DN	glasstube 15 x 2,5 Ident number	plexiglasstube 13 x 1,5 Ident number	protecting tube Ident number
10	○ 899.00.6G0.0000	○ 899.00.6Y0.0000	○ 189.00.110.0001

spherical cap base (930K)

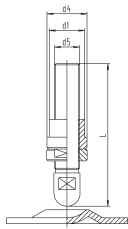

DN	d1	d4	d5	l	weight (kg)
3/8"	23.7	26.9	3/8"	100	0,780
1/2"	29.7	33.7	1/2"	120	1,010
1"	44.3	48.3	1"	150	1,540
1 1/2"	56.3	60.3	1 1/2"	150	2,860

base disc for height adjustable stainless steel feet, 3/8" to 1 1/2" (930T)

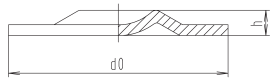

DN	d0	h	weight (kg)
3/8" - 1 1/2"	102	13	0,330

t-pieces, short, DIN 11852 (for tubing acc. DIN 11850 line 2) (311IN)

DN	304 polished Ident number
3/8"	● 182.04.110.0000
1/2"	● 182.06.110.0000
1"	● 182.08.110.0000
1 1/2"	● 182.10.110.0000

t-pieces, short, DIN 11852 (for tubing acc. DIN 11850 line 2) (311IN)

DN	304 polished Ident number
3/8" - 1 1/2"	● 182.04.110.0003