

Non return valves



On the following pages you will find the article numbers required for inquiries and orders of the **non return valves**, accessories, and spare parts of our catalogue program.

You will also find drawings with the installation dimensions.

The description of the products and all technical data sheets will be available on our new website, soon.

If you have any question, are looking for a different version, or if you would like to place an order, please send an e-mail to our sales team at **sales@nocado.de**.

Please keep in mind that it's necessary that you have to define and communicate the following characteristics so that we can process your request:

1. Product type / version
2. Size
3. Material steel with product contact
4. Material seals with product contact
5. Finish steel
6. Tube connections
7. Operation
8. Position sensors / control
9. Certificates

Instead of the a.m. characteristics you can send us the **Nocado article number**.

Notice:

All products of Nocado GmbH are under constant technical review. So, changes are reserved. Therefore, the technical data, images, and descriptions in our catalogue are therefore non-binding and exclude claims that may be derived from them.

The data in our catalogue is based on the status at the date of its publishing. Earlier catalogues become void, automatically.

All rights are reserved by Nocado GmbH. Reprints, copies, translations, and use on your websites or in your webshop, even if only partially, require the prior written approval of Nocado GmbH.

1.9 Non return valves

1.9.1 Non return valves • Disk type

page

Check valve, disk type, weld ends (for tubing according to DIN 11850 line 2) (770S)	1.9.1-1
Check valve, disk type, between flanges (for tubing according to DIN 11850 line 2).....	1.9.1-1
Check valve, disk type, between flanges (welding bevel according to DIN 11850) (770N)	1.9.1-1
Check valve, disk type, weld ends, inch OD (770Z)	1.9.1-1
Check valve, disk type, between flanges, inch OD.....	1.9.1-3
Check valve, disk type, male / weld end (weld. bevel according to DIN 11850) (770)	1.9.1-3
Check valve, disk type, male / weld end, inch OD (770Z).....	1.9.1-3

1.9.2 Non return valves • Ball type

Check valve, ball type, weld ends (according to DIN 11850 line 2) (770K).....	1.9.2-1
Check valve, ball type, weld ends, inch OD (770K)	1.9.2-1
Check valve, ball type, DIN 11851 male / weld end DIN (770K)	1.9.2-1
Check valve, ball type, DIN 11851 male / weld end inch OD (770K)	1.9.2-1

1.9.3 Non return valves • Spare parts

Spring for check valve, disk type.....	1.9.3-1
Spring for check valve, disk type between flanges.....	1.9.3-1
Set of gaskets for check valve, disk type.....	1.9.3-1
Set of gaskets for check valve, disk type between flanges.....	1.9.3-1
Ball for check valve, ball type.....	1.9.3-3

check valve, disk type, weld ends (for tub. acc. DIN 11850 line 2) (770S)

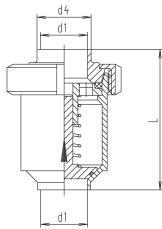

DN	d1	d4	l	weight (kg)
25	26	29	81	1,020
32	32	35	96	1,140
40	38	41	106	2,120
50	50	53	107	2,430
65	66	70	132	3,580
80	81	85	151	5,780
100	100	104	170	9,660

check valve, disk type, betw. flanges (for tub. acc. DIN 11850 line 2)

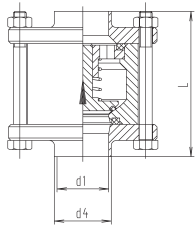

DN	d1	d4	l	weight (kg)
25	26	29	90	1,650
32	32	35	90	2,020
40	38	41	100	1,990
50	50	53	110	2,530
65	66	70	120	3,270
80	81	85	145	5,900
100	100	104	150	9,800

check valve, disk type, betw. flanges (weld. bevel acc. DIN 11850) (770N)

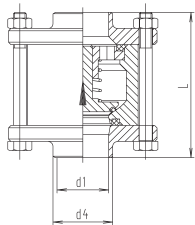

DN	d1	d4	l	weight (kg)
25	26	31	90	1,650
32	32	37	90	2,020
40	38	43	100	1,990
50	50	55	110	2,530
65	66	72	120	3,270
80	81	87	145	5,900
100	100	106	150	9,800

check valve, disk type, weld ends, inch OD (770Z)

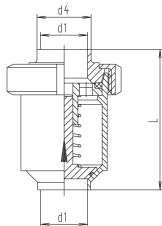

DN	d1	d4	l	weight (kg)
25	22.1	25.4	73	1,020
32	28.5	31.8	96	1,140
40	34.8	38.1	106	2,120
50	47.5	50.8	107	2,430
65	60.2	63.5	132	3,580
80	72.9	76.1	151	5,780
100	97.4	101.6	170	9,660

check valve, disk type, weld ends (for tub. acc. DIN 11850 line 2) (770S)

DN	304 NBR polished Ident number	304 NBR matt Ident number	316 L NBR polished Ident number	316 L NBR matt Ident number
25	o 167.08.11N.0025	o 167.08.21N.0025	o 167.08.12N.0025	o 167.08.22N.0025
32	o 167.09.11N.0025	o 167.09.21N.0025	o 167.09.12N.0025	o 167.09.22N.0025
40	o 167.10.11N.0025	o 167.10.21N.0025	o 167.10.12N.0025	o 167.10.22N.0025
50	o 167.11.11N.0025	o 167.11.21N.0025	o 167.11.12N.0025	o 167.11.22N.0025
65	o 167.12.11N.0025	o 167.12.21N.0025	o 167.12.12N.0025	o 167.12.22N.0025
80	o 167.14.11N.0025	o 167.14.21N.0025	o 167.14.12N.0025	o 167.14.22N.0025
100	o 167.15.11N.0025	o 167.15.21N.0025	o 167.15.12N.0025	o 167.15.22N.0025

check valve, disk type, betw. flanges (for tub. acc. DIN 11850 line 2)

DN	304 NBR polished Ident number	304 NBR matt Ident number	316 L NBR polished Ident number	316 L NBR matt Ident number
25	o 167.08.11N.0027	o 167.08.21N.0027	o 167.08.12N.0027	o 167.08.22N.0027
32	o 167.09.11N.0027	o 167.09.21N.0027	o 167.09.12N.0027	o 167.09.22N.0027
40	o 167.10.11N.0027	o 167.10.21N.0027	o 167.10.12N.0027	o 167.10.22N.0027
50	o 167.11.11N.0027	o 167.11.21N.0027	o 167.11.12N.0027	o 167.11.22N.0027
65	o 167.12.11N.0027	o 167.12.21N.0027	o 167.12.12N.0027	o 167.12.22N.0027
80	o 167.14.11N.0027	o 167.14.21N.0027	o 167.14.12N.0027	o 167.14.22N.0027
100	o 167.15.11N.0027	o 167.15.21N.0027	o 167.15.12N.0027	o 167.15.22N.0027

check valve, disk type, betw. flanges (weld. bevel acc. DIN 11850) (770N)

DN	304 NBR polished Ident number	304 NBR matt Ident number	316 L NBR polished Ident number	316 L NBR matt Ident number
25	o 167.08.11N.0007	o 167.08.21N.0007	o 167.08.12N.0007	o 167.08.22N.0007
32	o 167.09.11N.0007	o 167.09.21N.0007	o 167.09.12N.0007	o 167.09.22N.0007
40	o 167.10.11N.0007	o 167.10.21N.0007	o 167.10.12N.0007	o 167.10.22N.0007
50	o 167.11.11N.0007	o 167.11.21N.0007	o 167.11.12N.0007	o 167.11.22N.0007
65	o 167.12.11N.0007	o 167.12.21N.0007	o 167.12.12N.0007	o 167.12.22N.0007
80	o 167.14.11N.0007	o 167.14.21N.0007	o 167.14.12N.0007	o 167.14.22N.0007
100	o 167.15.11N.0007	o 167.15.21N.0007	o 167.15.12N.0007	o 167.15.22N.0007

check valve, disk type, weld ends, inch OD (770Z)

DN	304 NBR polished Ident number	304 NBR matt Ident number	316 L NBR polished Ident number	316 L NBR matt Ident number
25	o 167.08.11N.0026	o 167.08.21N.0026	o 167.08.12N.0026	o 167.08.22N.0026
32	o 167.09.11N.0026	o 167.09.21N.0026	o 167.09.12N.0026	o 167.09.22N.0026
40	o 167.10.11N.0026	o 167.10.21N.0026	o 167.10.12N.0026	o 167.10.22N.0026
50	o 167.11.11N.0026	o 167.11.21N.0026	o 167.11.12N.0026	o 167.11.22N.0026
65	o 167.12.11N.0026	o 167.12.21N.0026	o 167.12.12N.0026	o 167.12.22N.0026
80	o 167.13.11N.0026	o 167.13.21N.0026	o 167.13.12N.0026	o 167.13.22N.0026
100	o 167.15.11N.0026	o 167.15.21N.0026	o 167.15.12N.0026	o 167.15.22N.0026

check valve, disk type, betw. flanges, inch OD

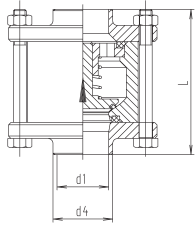

DN	d1	d4	l	weight (kg)
1"	22.1	25.4	90	1,650
1 1/4"	28.5	31.8	90	2,020
1 1/2"	34.8	38.1	100	1,990
2"	47.5	50.8	110	2,530
2 1/2"	60.2	63.5	120	3,270
3"	72.9	76.2	145	5,900
4"	97.4	101.6	150	9,800

check valve, disk type, male / weld end (weld. bevel acc. DIN 11850) (770)

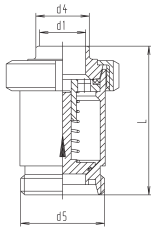

DN	d1	d4	d5	l	weight (kg)
25	26	31	52x1/6"	88	1,080
32	32	37	58x1/6"	103	1,200
40	38	43	65x1/6"	113	2,200
50	50	55	78x1/6"	114	2,550
65	66	72	95x1/6"	140	3,700
80	81	87	110x1/4"	159	5,900
100	100	106	130x1/4"	180	9,800

check valve, disk type, male/ weld end, inch OD (770Z)

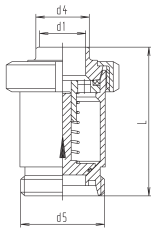

DN	d1	d4	d5	l	weight (kg)
1"	22.1	25.4	52x1/6"	80	1,080
1 1/4"	28.5	31.8	58x1/6"	103	1,200
1 1/2"	34.8	38.1	65x1/6"	113	2,200
2"	47.5	50.8	78x1/6"	114	2,550
2 1/2"	60.2	63.5	95x1/6"	140	3,700
3"	72.9	76.1	104x1/6"	159	5,900
4"	97.4	101.6	130x1/4"	180	9,800

check valve, disk type, betw. flanges, inch OD

DN	304 NBR polished Ident number	304 NBR matt Ident number	316 L NBR polished Ident number	316 L NBR matt Ident number
1"	○ 167.08.11N.0012	○ 167.08.21N.0012	○ 167.08.12N.0012	○ 167.08.22N.0012
1 1/4"	○ 167.09.11N.0012	○ 167.09.21N.0012	○ 167.09.12N.0012	○ 167.09.22N.0012
1 1/2"	○ 167.10.11N.0012	○ 167.10.21N.0012	○ 167.10.12N.0012	○ 167.10.22N.0012
2"	○ 167.11.11N.0012	○ 167.11.21N.0012	○ 167.11.12N.0012	○ 167.11.22N.0012
2 1/2"	○ 167.12.11N.0012	○ 167.12.21N.0012	○ 167.12.12N.0012	○ 167.12.22N.0012
3"	○ 167.13.11N.0012	○ 167.13.21N.0012	○ 167.13.12N.0012	○ 167.13.22N.0012
4"	○ 167.15.11N.0012	○ 167.15.21N.0012	○ 167.15.12N.0012	○ 167.15.22N.0012

check valve, disk type, male / weld end (weld. bevel acc. DIN 11850) (770)

DN	304 NBR polished Ident number	304 NBR matt Ident number	316 L NBR polished Ident number	316 L NBR matt Ident number
25	○ 167.08.11N.0003	○ 167.08.21N.0003	○ 167.08.12N.0003	○ 167.08.22N.0003
32	○ 167.09.11N.0003	○ 167.09.21N.0003	○ 167.09.12N.0003	○ 167.09.22N.0003
40	○ 167.10.11N.0003	● 167.10.21N.0003	○ 167.10.12N.0003	○ 167.10.22N.0003
50	● 167.11.11N.0003	● 167.11.21N.0003	○ 167.11.12N.0003	● 167.11.22N.0003
65	○ 167.12.11N.0003	○ 167.12.21N.0003	○ 167.12.12N.0003	○ 167.12.22N.0003
80	○ 167.14.11N.0003	○ 167.14.21N.0003	○ 167.14.12N.0003	○ 167.14.22N.0003
100	● 167.15.11N.0003	○ 167.15.21N.0003	○ 167.15.12N.0003	○ 167.15.22N.0003

check valve, disk type, male/ weld end, inch OD (770Z)

DN	304 NBR polished Ident number	304 NBR matt Ident number	316 L NBR polished Ident number	316 L NBR matt Ident number
1"	○ 167.08.11N.0004	○ 167.08.21N.0004	○ 167.08.12N.0004	○ 167.08.22N.0004
1 1/4"	○ 167.09.11N.0004	○ 167.09.21N.0004	○ 167.09.12N.0004	○ 167.09.22N.0004
1 1/2"	○ 167.10.11N.0004	○ 167.10.21N.0004	○ 167.10.12N.0004	○ 167.10.22N.0004
2"	○ 167.11.11N.0004	○ 167.11.21N.0004	○ 167.11.12N.0004	○ 167.11.22N.0004
2 1/2"	○ 167.12.11N.0004	○ 167.12.21N.0004	○ 167.12.12N.0004	○ 167.12.22N.0004
3"	○ 167.13.11N.0004	○ 167.13.21N.0004	○ 167.13.12N.0004	○ 167.13.22N.0004
4"	○ 167.15.11N.0004	○ 167.15.21N.0004	○ 167.15.12N.0004	○ 167.15.22N.0004

check valve, ball type, weld ends (acc. DIN 11850 line 2) (770K)

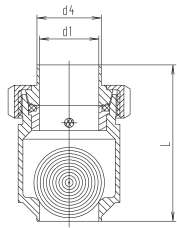

DN	d1	d4	L	weight (kg)
25	26	29	91	-
32	32	35	96	-
40	38	41	100	-
50	50	53	112	-
65	66	70	161	-
80	81	85	201	-

check valve, ball type, weld ends, inch OD (770K)

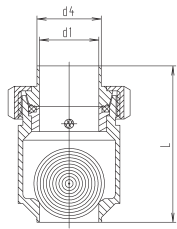

DN	d1	d4	L	weight (kg)
1"	22.1	25.4	90	-
1¼"	28.5	31.8	96	-
1½"	34.8	38.1	100	-
2"	47.5	50.8	112	-
2½"	60.2	63.5	161	-
3"	72.9	76.1	201	-

check valve, ball type, DIN 11851 male / weld end (770K)

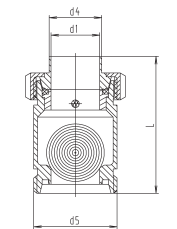

DN	d1	d4	d5	L	weight (kg)
25	26	31	52x1/6"	97	-
32	32	37	58x1/6"	103	-
40	38	43	65x1/6"	107	-
50	50	55	78x1/6"	119	-
65	66	72	95x1/6"	169	-
80	81	87	110x1/4"	209	-

check valve, ball type, DIN 11851 male / weld end inch OD (770K)

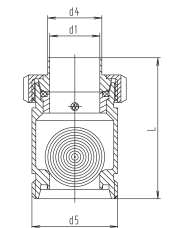

DN	d1	d4	d5	L	weight (kg)
1"	22.1	25.4	52x1/6"	97	-
1¼"	28.5	31.8	58x1/6"	103	-
1½"	34.8	38.1	65x1/6"	107	-
2"	47.5	50.8	78x1/6"	119	-
2½"	60.2	63.5	95x1/6"	169	-
3"	72.9	76.1	104x1/6"	209	-

check valve, ball type, weld ends (acc. DIN 11850 line 2) (770K)

DN	304 EPDM polished Ident number	304 NBR polished Ident number	316 L EPDM polished Ident number	316 L NBR polished Ident number
25	o 167.08.11E.0019	o 167.08.11N.0019	o 167.08.12E.0019	o 167.08.12N.0019
32	o 167.09.11E.0019	o 167.09.11N.0019	o 167.09.12E.0019	o 167.09.12N.0019
40	o 167.10.11E.0019	o 167.10.11N.0019	o 167.10.12E.0019	o 167.10.12N.0019
50	o 167.11.11E.0019	o 167.11.11N.0019	o 167.11.12E.0019	o 167.11.12N.0019
65	o 167.12.11E.0019	o 167.12.11N.0019	o 167.12.12E.0019	o 167.12.12N.0019
80	o 167.14.11E.0019	o 167.14.11N.0019	o 167.14.12E.0019	o 167.14.12N.0019

check valve, ball type, weld ends, inch OD (770K)

DN	304 EPDM polished Ident number	304 NBR poliert Ident number	316 L EPDM polished Ident number	316 L NBR polished Ident number
1"	o 167.08.11E.0021	o 167.08.11N.0021	o 167.08.12E.0021	o 167.08.12N.0021
1¼"	o 167.09.11E.0021	o 167.09.11N.0021	o 167.09.12E.0021	o 167.09.12N.0021
1½"	o 167.10.11E.0021	o 167.10.11N.0021	o 167.10.12E.0021	o 167.10.12N.0021
2"	o 167.11.11E.0021	o 167.11.11N.0021	o 167.11.12E.0021	o 167.11.12N.0021
2½"	o 167.12.11E.0021	o 167.12.11N.0021	o 167.12.12E.0021	o 167.12.12N.0021
3"	o 167.13.11E.0021	o 167.13.11N.0021	o 167.13.12E.0021	o 167.13.12N.0021

check valve, ball type, DIN 11851 male / weld end (770K)

DN	304 EPDM polished Ident number	304 NBR poliert Ident number	316 L EPDM polished Ident number	316 L NBR polished Ident number
25	o 167.08.11E.0010	o 167.08.11N.0010	o 167.08.12E.0010	o 167.08.12N.0010
32	o 167.09.11E.0010	o 167.09.11N.0010	o 167.09.12E.0010	o 167.09.12N.0010
40	o 167.10.11E.0010	o 167.10.11N.0010	o 167.10.12E.0010	o 167.10.12N.0010
50	o 167.11.11E.0010	o 167.11.11N.0010	o 167.11.12E.0010	o 167.11.12N.0010
65	o 167.12.11E.0010	o 167.12.11N.0010	o 167.12.12E.0010	o 167.12.12N.0010
80	o 167.14.11E.0010	o 167.14.11N.0010	o 167.14.12E.0010	o 167.14.12N.0010

check valve, ball type, DIN 11851 male / weld end inch OD (770K)

DN	304 EPDM polished Ident number	304 NBR poliert Ident number	316 L EPDM polished Ident number	316 L NBR polished Ident number
1"	o 167.08.11E.0022	o 167.08.11N.0022	o 167.08.12E.0022	o 167.08.12N.0022
1¼"	o 167.09.11E.0022	o 167.09.11N.0022	o 167.09.12E.0022	o 167.09.12N.0022
1½"	o 167.10.11E.0022	o 167.10.11N.0022	o 167.10.12E.0022	o 167.10.12N.0022
2"	o 167.11.11E.0022	o 167.11.11N.0022	o 167.11.12E.0022	o 167.11.12N.0022
2½"	o 167.12.11E.0022	o 167.12.11N.0022	o 167.12.12E.0022	o 167.12.12N.0022
3"	o 167.13.11E.0022	o 167.13.11N.0022	o 167.13.12E.0022	o 167.13.12N.0022

spring for check valve, disk type

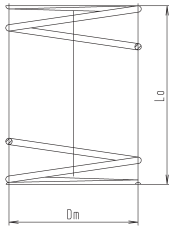

DN	Dm	Lo	weight (kg)
25 / 1"	19	50	-
32 / 1¼"	21.5	62	-
40 / 1½"	25	67	-
50 / 2"	25	79	-
65-80	30.5	100	-
2½"-3"	30.5	100	-
100 / 4"	32	100	-

spring for check valve, disk type betw. flanges

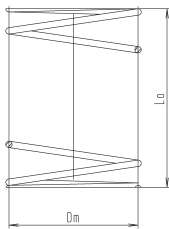

DN	Dm	Lo	weight (kg)
15-25 / 1"	19	39	-
32 / 1¼"	21.6	40	-
40 / 1½"	24.8	38	-
50 / 2"	24.8	68	-
65 / 2½"	30	85	-
80 / 3"	30.5	85	-
100 / 4"	32	71	-

set of gaskets for check valve, disk type

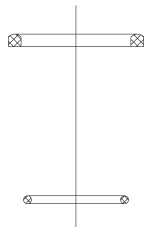

DN	weight (kg)
25 / 1"	0,006
32 / 1¼"	0,008
40 / 1½"	0,010
50 / 2"	0,012
65 / 2 ½"	0,016
80 / 3"	0,018
100 / 4"	0,026

set of gaskets for check valve, disk type betw. flanges

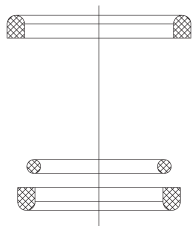

DN	weight (kg)
15-25 / 1"	-
32 / 1¼"	-
40 / 1½"	-
50 / 2"	-
65 / 2½"	-
80 / 3"	-
100 / 4"	-

spring for check valve, disk type

DN	Ident number
25 / 1"	○ 831.00.680.0015
32 / 1¼"	○ 831.00.680.0019
40 / 1½"	○ 831.00.680.0027
50 / 2"	○ 831.00.680.0028
65-80	○ 831.00.680.0039
2½"-3"	○ 831.00.680.0039
100 / 4"	○ 831.00.680.0042

spring for check valve, disk type betw. flanges

DN	Ident number
15-25 / 1"	○ 831.00.680.0085
32 / 1¼"	○ 831.00.680.0086
40 / 1½"	○ 831.00.680.0087
50 / 2"	○ 831.00.680.0088
65 / 2½"	○ 831.00.680.0089
80 / 3"	○ 831.00.680.0091
100 / 4"	○ 831.00.680.0092

set of gaskets for check valve, disk type

DN	EPDM	NBR
	Ident number	Ident number
25 / 1"	○ 267.08.6E0.0055	○ 267.08.6N0.0055
32 / 1¼"	○ 267.09.6E0.0055	○ 267.09.6N0.0055
40 / 1½"	○ 267.10.6E0.0055	○ 267.10.6N0.0055
50 / 2"	○ 267.11.6E0.0055	○ 267.11.6N0.0055
65 / 2 ½"	○ 267.12.6E0.0055	○ 267.12.6N0.0055
80 / 3"	○ 267.14.6E0.0055	○ 267.14.6N0.0055
100 / 4"	○ 267.15.6E0.0055	○ 267.15.6N0.0055

set of gaskets for check valve, disk type betw. flanges

DN	EPDM	NBR
	Ident number	Ident number
15-25 / 1"	○ 267.08.6E0.0056	○ 267.08.6N0.0056
32 / 1¼"	○ 267.09.6E0.0056	○ 267.09.6N0.0056
40 / 1½"	○ 267.10.6E0.0056	○ 267.10.6N0.0056
50 / 2"	○ 267.11.6E0.0056	○ 267.11.6N0.0056
65 / 2½"	○ 267.12.6E0.0056	○ 267.12.6N0.0056
80 / 3"	○ 267.14.6E0.0056	○ 267.14.6N0.0056
100 / 4"	○ 267.15.6E0.0056	○ 267.15.6N0.0056

ball for check valve, ball type

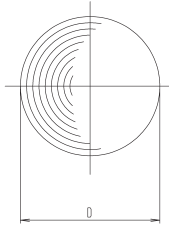

DN	weight (kg)
25 / 1"	-
32 / 1¼"	-
40 / 1½"	-
50 / 2"	-
65 / 2½"	-
3"	-
80	-

ball for check valve, ball type

DN	EPDM	NBR	PTFE
	Ident number	Ident number	Ident number
25 / 1"	○ 895.08.6E0.0046	○ 895.08.6N0.0046	○ 895.08.6T0.0046
32 / 1¼"	○ 895.09.6E0.0046	○ 895.09.6N0.0046	○ 895.09.6T0.0046
40 / 1½"	○ 895.10.6E0.0046	○ 895.10.6N0.0046	○ 895.10.6T0.0046
50 / 2"	○ 895.11.6E0.0046	○ 895.11.6N0.0046	○ 895.11.6T0.0046
65 / 2½"	○ 895.12.6E0.0046	○ 895.12.6N0.0046	○ 895.12.6T0.0046
3"	○ 895.13.6E0.0046	○ 895.13.6N0.0046	○ 895.13.6T0.0046
80	○ 895.14.6E0.0046	○ 895.14.6N0.0046	○ 895.14.6T0.0046